

Received
Planning Division
08/04/2023

Land Use Luminaire Cut Sheets

**Elmonica Affordable Housing Full Design
2021-1320**

Prepared for:

Salazar Architects Inc.

Prepared by:

Deborah Raines, MIES

May 12, 2022

LINEA 600 LVC

Specification

The LINEA series features distinctly linear design qualities and exceptional versatility. Perceptively capturing today's minimal design philosophy, the reduced form is sure to retain its validity far into the future. It is available in three mounting heights in single or twin mounting configurations. The pedestrian-scale model is 15 feet, with intermediate and larger sizes at 20 and 26 feet, respectively, giving proper scale for a variety of applications. Units for bi-level mounting are available, where the street-side luminaire is mounted high and a second fixture is mounted on the sidewalk side at a lower height for pedestrian illumination. An LED illuminating bollard for low-level pathway illumination complements the family of products. CSA Listed for Wet Locations

**TYPE SA
(TYPE SA1 POLE ONLY)**



LED Model	LED Module	Color Temperature	Distribution	Volt	Mounting	Pole	Pole Mat	Finish	Option
LN600	4LVC - 4 modules	WW - 3000K	T2 - Type II	UNV - 120-277V	A - Single Mount	20SR - 20' Straight Rectangular	A - AluminSG	SG - Silver Grey	DIM - 0-10vDC Dimming
		NW - 4000K	T3 - Type III		B - Twin Mount	X - Other (specify)	S - Steel	DG - Dark Grey	N - None
			T4 - Type IV					GG - Graphite Grey	HSS - House Side Shield
								BLK - Matte Black	
								BRZ - Dark Bronze	
								CC - Custom RAL Color	

Ordering Information

Specifications are subject to change without notification

LINEA 600 LVC

Specification

HOUSING

Rectangular luminaire housing with integral fitter is extruded aluminum. Frameless tempered glass lens is hinged and secured in place with a single stainless steel quarter-turn fastener for tool-less access to the optical compartment. Lens seals to the housing with one-piece silicone gasketing when closed. Housing is fitted with stainless steel weather-tight strain relief bushing for the power cable exiting the rear of the housing. Luminaire mounts to tenon on pole with matching profile and secured with four socket head cap screws on top of the housing. Luminaire is available in single or twin back-to-back mounting configurations All hardware is stainless steel.

OPTICS

Optics include four individual LED modules. Each module consists of a field replaceable aluminum core PCB with four high-power LEDs and a single piece lens molded from optical quality acrylic. Light distributions include a choice of Type II, III, or IV optics. Luminaire emits zero uplight at 90 degrees horizontal and above and is suitable for use in all LEED lighting zones. CRI is 80+. Optional internal house side shield available on request.

4 Modules: 144 watts

Type II - 3000K: 13588 lumens / B2-U0-G2

Type III - 3000K: 12918 lumens / B3-U0-G2

Type IV - 3000K: 12156 lumens / B2-U0-G2

Type II - 4000K: 14754 lumens / B3-U0-G2

Type III - 4000K: 14027 lumens / B3-U0-G2

Type IV - 4000K: 13199 lumens / B2-U0-G2

NOTE : Due to rapid and continuous advances in LED technology, LED luminaire data is subject to change without notice and at the discretion of HessAmerica. Consult factory for more current technical data.

ELECTRICAL

Electronic LED driver supplies 700mA drive current to LED modules with input voltage range from 120v through 277v at 50/60Hz. Power consumption is 144 watts. Optional 0-10v DC dimming is available on request.

LUMINAIRE WEIGHT: 26 lbs

LUMINAIRE EPA: 1.6 sq. ft

POLE

Aluminum:

Straight rectangular pole is 6.3" x 3.9" nominal and manufactured from seamless 6061 aluminum tubing and heat treated to produce a T6 temper. Nominal wall thickness is 0.236". Sides of the shaft are flat with 1/8" radiussed corners. Flush mounted hand hole cover is plasma cut with kerf not to exceed 1/8" and includes triangular tamper-resistant locking device. Two piece base cover is fabricated aluminum. Nominal pole height is 20'.

Steel:

Straight rectangular pole is 6.3" x 4.7" nominal and manufactured from cold drawn over mandrel, electric-weld, mechanical rectangular steel tubing with nominal wall thickness of 0.197". Sides of shaft are flat with 1/2" radiussed corners. Pole shall show no seam along shaft. Flush mounted hand hole cover is plasma cut with kerf not to exceed 1/8" and includes triangular tamper-resistant locking device. Pole is hot-dip galvanized with coating inside and out, then lightly sanded prior to painting. Two piece base cover is fabricated aluminum. Nominal pole height is 20'.

FINISH

Specifications are subject to change without notification

Additional information

Dimensions

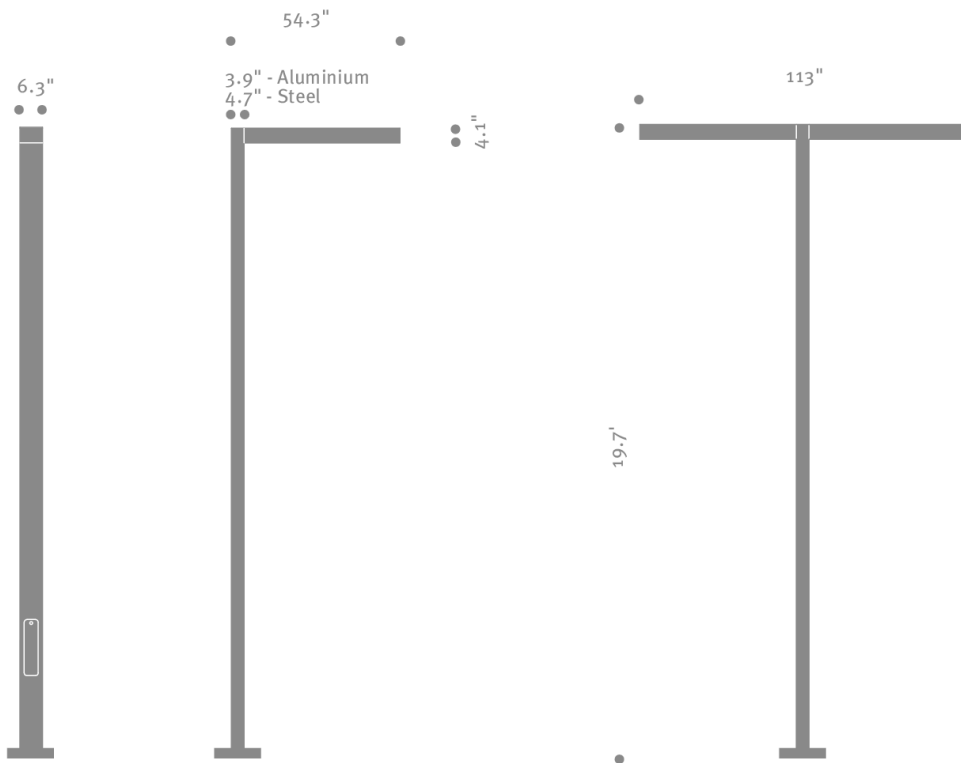

Mounting detail

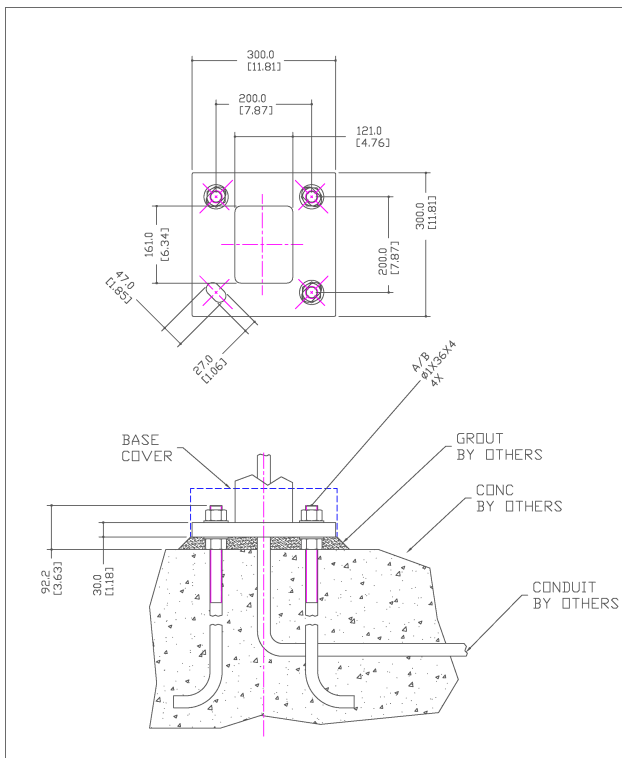

Specifications are subject to change without notification

HessAmerica > Products > Lighting Products > Pole Mounted Luminaire > LINEA
https://www.hessamerica.com/Products/Lighting/Pole_Mounted_Luminaire/LINEA/

LINEA 450 LVC Specification

The LINEA series features distinctly linear design qualities and exceptional versatility. Perceptively capturing today's minimal design philosophy, the reduced form is sure to retain its validity far into the future. It is available in three mounting heights in single or twin mounting configurations. The pedestrian-scale model is 15 feet, with intermediate and larger sizes at 20 and 26 feet, respectively, giving proper scale for a variety of applications. Units for bi-level mounting are available, where the street-side luminaire is mounted high and a second fixture is mounted on the sidewalk side at a lower height for pedestrian illumination. An LED illuminating bollard for low-level pathway illumination complements the family of products. CSA Listed for Wet Locations

TYPE SB



LED Model	LED Module	Color Temperature	Distribution	Volt	Mounting	Pole	Pole Mat	Finish	Option
LN450	2LVC - 2 modules	WW - 3000K	T2 - Type II	UNV - 120-277V	A - Single Mount	15SR - 15' Straight Rectangular	A - AluminSG	Silver Grey	DIM - 0-10vDC Dimming
		NW - 4000K	T3 - Type III		B - Twin Mount	X - Other (specify)	S - Steel	DG - Dark Grey	N - None
			T4 - Type IV					GG - Graphite Grey	HSS - House Side Shield
								BLK - Matte Black	
								BRZ - Dark Bronze	
								CC - Custom RAL Color	

Ordering Information

Specifications are subject to change without notification

LINEA 450 LVC

Specification

HOUSING

Rectangular luminaire housing with integral fitter is extruded aluminum with no visible welds. Frameless tempered glass lens with decorative masking is hinged and secured in place with a single stainless steel quarter-turn fastener for tool-less access to the optical compartment. Lens seals to the housing with one-piece silicone gasketing when closed. Housing is fitted with stainless steel weather-tight strain relief bushing for the power cable exiting the rear of the housing. Luminaire mounts to tenon on pole and secured with four socket head cap screws on top of the housing. Luminaire is available in single or twin back-to-back mounting configurations. All hardware is stainless steel.

OPTICS

Optics include 2 individual LED modules. Each module consists of a field replaceable aluminum core PCB with four high-power LEDs and a single piece lens molded from optical quality acrylic. Light distributions include a choice of Type II, III, or IV optics. Luminaire emits zero uplight at 90 degrees horizontal and above and is suitable for use in all LEED lighting zones. Optional internal house side shield available on request.

LED DELIVERED LUMEN OUTPUT / BUG RATING

2 Modules: 72 watts

Type II - 3000K: 6794 lumens / B1-U0-G1

Type III - 3000K: 6459 lumens / B2-U0-G1

Type IV - 3000K: 6078 lumens / B1-U0-G1

Type II - 4000K: 7377 lumens / B2-U0-G1

Type III - 4000K: 7013 lumens / B2-U0-G1

Type IV - 4000K: 6599 lumens / B1-U0-G2

NOTE : Due to rapid and continuous advances in LED technology, LED luminaire data is subject to change without notice and at the discretion of HessAmerica. Consult factory for current technical data.

ELECTRICAL

Electronic LED driver supplies 700mA drive current to LED modules with input voltage range from 120v through 277v at 50/60Hz. Power consumption is 72 watts. Optional 0-10v DC dimming is available on request.

LUMINAIRE WEIGHT: 22 lbs

LUMINAIRE EPA: 1.3 sq. ft

POLE

Aluminum:

Straight rectangular pole is 6.3" x 3.9" nominal and manufactured from seamless 6061 aluminum tubing and heat treated to produce a T6 temper. Nominal wall thickness is 0.236". Sides of the shaft are flat with 1/8" radiussed corners. Flush mounted hand hole cover is plasma cut with kerf not to exceed 1/8" and includes triangular tamper-resistant locking device. Two piece base cover is fabricated aluminum. Nominal pole height is 15'.

Steel:

Straight rectangular pole is 6.3" x 3.5" nominal and manufactured from cold drawn over mandrel, electric weld, mechanical steel tubing with nominal wall thickness of 0.197". Sides of shaft are flat with 1/2" radiussed corners. Pole shall show no seam along the shaft. Flush mounted hand hole cover is plasma cut with kerf not to exceed 1/8" and includes triangular tamper-resistant locking device. Pole is hot-dip galvanized with coating inside and out, then lightly sanded prior to painting. Two piece base cover is fabricated aluminum. Nominal pole height is 15'.

FINISH

Specifications are subject to change without notification

HessAmerica > Products > Lighting Products > Pole Mounted Luminaire > LINEA
https://www.hessamerica.com/Products/Lighting/Pole_Mounted_Luminaire/LINEA/

Additional information

Dimensions

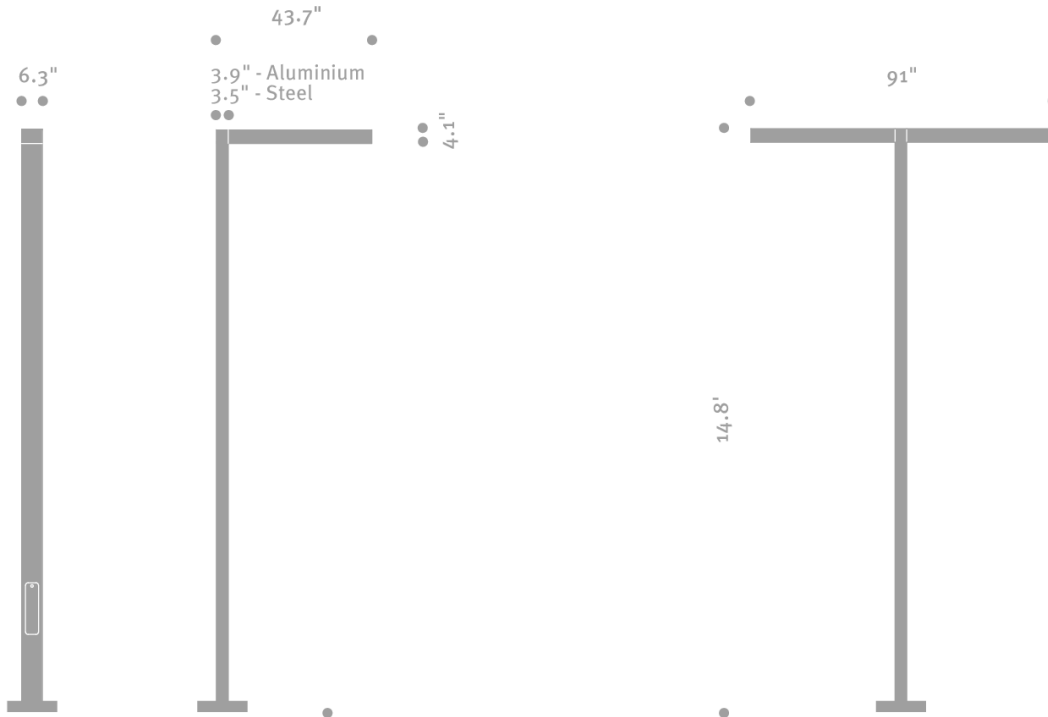

Mounting detail

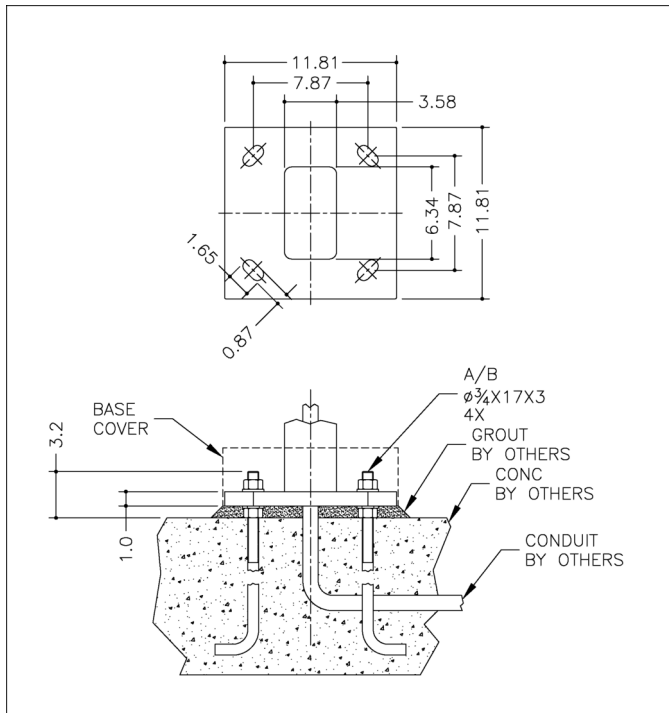

Specifications are subject to change without notification

ULEE-30001

Leeds 2 Small Surface Downlight



TYPE SC



5.5w LED 570 Lumens
IP65 • Suitable For Wet Locations
IK07 • Impact Resistant
Weight 1.7 lbs

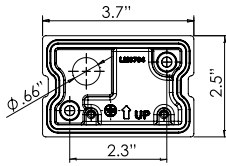
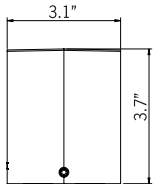
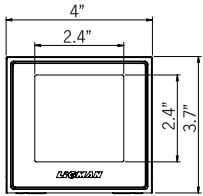

Mounting Detail

4" junction box cover plate is available as an option

Construction

Aluminum

Less than 0.1% copper content - Marine Grade 6060 extruded & LM6 Aluminum High Pressure die casting provides excellent mechanical strength, clean detailed product lines and excellent heat dissipation.

Pre paint

8 step degrease and phosphate process that includes deoxidizing and etching as well as a zinc and nickel phosphate process before product painting.

Memory Retentive -Silicon Gasket

Provided with special injection molded "fit for purpose" long life high temperature memory retentive silicon gaskets. Maintains the gaskets exact profile and seal over years of use and compression.

Thermal management

LM6 Aluminum is used for its excellent mechanical strength and thermal dissipation properties in low and high ambient temperatures. The superior thermal heat sink design by Ligman used in conjunction with the driver, controls thermals below critical temperature range to ensure maximum luminous flux output, as well as providing long LED service life and ensuring less than 10% lumen depreciation at 50,000 hours.

Surge Suppression

Standard 10kv surge suppressor provided with all fixtures.

BUG Rating

B0 - U0 - G0

Finishing

All Ligman products go through an extensive finishing process that includes fettling to improve paint adherence.

Paint

UV Stabilized 4.9Mil thick powder coat paint and baked at 200 Deg C. This process ensures that Ligman products can withstand harsh environments. Rated for use in natatoriums.

Inspired by Nature Finishes

The Inspired by nature Finishing is a unique system of decorative powder coating. Our metal decoration process can easily transform the appearance of metal or aluminum product into a wood grain finish.

This patented technology enables the simulation of wood grain, and even marble or granite finish through the use of decorative powder coating.

The wood grain finish is so realistic that it's almost undistinguishable from real wood, even from a close visual inspection. The system of coating permeates the entire thickness of the coat and as a result, the coating cannot be removed by normal rubbing, chipping, or scratching.

The Coating Process

After pre-treatment the prepared parts are powder coated with a specially formulated polyurethane powder. This powder provides protection against wear, abrasion, impact and corrosion and acts as the relief base color for the finalized metal decoration.

The component is then wrapped with a sheet of non-porous film with the selected decoration pattern printed on it using special high temperature inks.

This printed film transfer is vacuum-sealed to the surface for a complete thermo print and then transferred into a customized oven. The oven transforms the ink into different forms within the paint layer before it becomes solid. Finally, the film is removed, and a vivid timber look on aluminum remains.

Wood grain coating can create beautiful wood-looking products of any sort. There are over 300 combinations of designs currently in use. Wood grains can be made with different colors, designs, etc.

Our powder coatings are certified for indoor and outdoor applications and are backed by a comprehensive warranty. These coatings rise to the highest conceivable standard of performance excellence and design innovation.

Added Benefits

- Resistance to salt-acid room, accelerated aging
- Boiling water, lime and condensed water resistant
- Anti-Graffiti, Anti-Slip, Anti-Microbial, Anti-Scratch
- Super durable (UV resistant)
- TGIC free (non-toxic)

Hardware

Provided Hardware is Marine grade 316 Stainless steel.

Anti Seize Screw Holes

Tapped holes are infused with a special anti seize compound designed to prevent seizure of threaded connections, due to electrolysis from heat, corrosive atmospheres and moisture.

Crystal Clear Low Iron Glass Lens

Provided with tempered, impact resistant crystal clear low iron glass ensuring no green glass tinge.

Optics & LED

Precise optic design provides exceptional light control and precise distribution of light. LED CRI > 80

Lumen - Maintenance Life

L80 /B10 at 50,000 hours (This means that at least 90% of the LED still achieve 80% of their original flux)

Clean, beautiful, surface wall fixtures with class leading performance. Minimalist form, yet the most powerful and flexible lighting tool of its type, offering packages up to 4000 lumens and microVos technology.

A range of small, square and rectangular, ADA compliant wall mounted luminaires with options of upward or downward light distributions. Ideally suited to illuminate the wall and surfaces in front of wall and for light accents on vertical surfaces using high efficiency LED's. The Leeds is suitable for indoor and outdoor applications and provides a clean, visually appealing solution for small, unobtrusive wall mounted luminaires.

This luminaire is available in 3 different sizes and in combinations of down, up or up/down light distributions.

This fixture utilizes microVos technology, meaning the ability to do Type I,II,III,IV & V distributions as well as hybrid distributions to suit the designer's requirements.

Using the microVos optics allows for very wide spacing to mounting height ratios, while still providing perfect uniformity and code compliant light levels.

The Leeds has been IDA Dark Sky certified for cct's of 3000K or lower.



Ligman's micro Variable Optical System provides the ability to interchange, mix & rotate optics to provide specific light distributions for optimized spacing and uniformity.

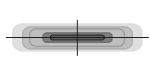

Type I

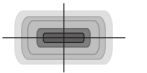

Type II

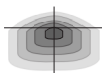

Type III

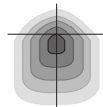

Type IV

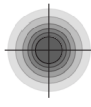

Type V

Additional Options (Consult Factory For Pricing)



SCDT
Surface Conduit Decorative Trim

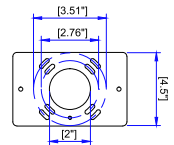

4MP
4" Octagonal J-Box
Mounting Plate

ULEE-30001

Leeds 2 Small Surface Downlight



PROJECT		DATE	
----------------	--	-------------	--

QUANTITY		TYPE		NOTE	
-----------------	--	-------------	--	-------------	--

ORDERING EXAMPLE || ULEE - 30001 - 5.5w - T2 - W30 - 02 - 120/277v - Options

ULEE-30001					
	LAMP	BEAM	LED COLOR	FINISH COLOR	VOLTAGE
	5.5w LED 570 Lumens	T1 - Type I Distribution T2 - Type II Distribution T3 - Type III Distribution T4 - Type IV Distribution M - Medium 30° W - Wide 56° EW - Extra Wide 99°x102°	W27 - 2700K W30 - 3000K W35 - 3500K W40 - 4000K	01 - BLACK RAL 9011 02 - DARK GREY RAL 7043 03 - WHITE RAL 9003 04 - METALLIC SILVER RAL 9006 05 - MATTE SILVER RAL 9006 06 - LIGMAN BRONZE 07 - CUSTOM RAL	120v/277v Other - Specify

INSPIRED BY NATURE FINISHES

- SW01 - OAK FINISH
- SW02 - WALNUT FINISH
- SW03- PINE FINISH
- DF - DOUGLAS FIR FINISH
- CW - CHERRY WOOD FINISH
- NW - NATIONAL WALNUT FINISH
- SU01 - CONCRETE FINISH
- SU02 - SOFTSCAPE FINISH
- SU03 - STONE FINISH
- SU04 - CORTEN FINISH

THERE IS AN ADDITIONAL COST FOR THESE FINISHES

--	--	--

ADDITIONAL OPTIONS

- NAT - Natatorium Rated
- 4MP - 4" Octagonal J-Box Mounting Plate
- SCDT - Surface Conduit Decorative Trim
- AMB - Turtle Friendly Amber LED
- F - Frosted Lens

More Custom Finishes Available Upon Request

Consult factory for pricing and lead times

Oak	Cherry	Beech	Carbon
Walnut	Chestnut	Bamboo	Galvanized
Pine	Mahogany	Birch	Steel



LTR-4RD

LITEISTRY 4" ROUND DOWNLIGHT

LITEISTRY™

FEATURES

- 4" architectural LED downlight delivering 600 – 4000 lm
- Five beam distributions from 0.3 to 1.2 Spacing Criteria
- Quiet reflector appearance with superior 50° optical cutoff
- 2700K – 5000K, 80+ and 90+ CRI options
- Available for New Construction (non-IC), IC and Chicago Plenum applications
- Variety of dimming protocol options including 0–10V, DALI, DMX, Lutron Forward Phase and EcoSystem
- NX Distributed Intelligence™ wired and wireless controls capability available



RELATED PRODUCTS

- Ø [LTR-4RD-RFH Retrofit](#)
- Ø [LTR-4RD SpectraSync](#)
- Ø [4" LITEISTRY Family](#)
- Ø [LTR-4RD PowerHUBB](#)

SERVICE PROGRAMS



CONTROL TECHNOLOGY



SPECIFICATIONS

CONSTRUCTION

- Standard Non-IC. Chicago Plenum and IC options
- Painted black durable steel platform with pre-installed bar hangers
- Pre-wired junction box with snap-on covers for easy access
- Snap-in connection from driver compartment allows easy installation
- Light Engine connections use plenum rated (CMP) cable

OPTICS

- Visually pleasing 50° cutoff to source and source image
- The light distribution is free of distracting bright spots or pixelation and the perimeter has a smooth transition
- Optical grade silicone lens integral to light engine
- High purity spun aluminum reflector, self-flanged
- Flush Mount flange option with mud-in ring available
- Large selection of anodized finishes and colors
- Painted cones and flange options available

ELECTRICAL

- Chip-on-board LED with 2 SDCM
- Multiple CCTs, 80+ or 90+ CRI
- Long LED life: L90 at >55,000 hours (TM-21)
- Universal voltage 120V–277V driver, 347V optional
- UL Class 2, inherent short circuit and overload protection, RoHS compliant
- Flicker free 0-10V dimming with 1% or <1% performance
- DALI, DMX, and Lutron Forward Phase and EcoSystem options
- Integral and remote emergency controller and battery pack options available
- NX or Lutron Vive control options available
- Refer to additional spec sheets for information on [SpectraSync™ Tunable White or Dim-to-Warm](#) or [PowerHUBB™ PoE enabled](#) solutions

INSTALLATION

- Accommodates ceiling thickness up to 2"
- Universal adjustable mounting brackets also accept 0.5" EMT conduit or 1.5" or 0.75" lathing channel (by others) or Prescolite accessory bar hangers (B24 or B6)
- Light Engine/Driver fully serviceable from above or below the ceiling

CERTIFICATIONS

- cCSAus certified to UL 1598
- Suitable for wet locations, covered ceiling. EM/ EMR: Suitable for damp locations.
- EM/EMR: Certified under UL 924 standard for emergency lighting and power equipment
- Approved for 8 (4 in/4 out) No. 12AWG conductors rated for 90°C through wiring
- ENERGY STAR® certified models available (See list and additional information on page 7)
- This product qualifies as a “designated country construction material” per FAR 52.225-11 Buy American-Construction. Materials under Trade Agreements effective 6/6/2020. See [Buy American Solutions](#).

WARRANTY

- 5 year warranty
- See [HLI Standard Warranty](#) for additional information

KEY DATA	
Lumen Range	600-4000
Wattage Range	8-52
Efficacy Range (LPW)	90-99*
Reported Life (Hours)	L90 / >55,000
Input Current (mA)	65-433 (120V)

*Based on Specular, 35K, 80 CRI



LTR-4RD

LITEISTRY 4" ROUND DOWNLIGHT

DATE: _____ LOCATION: _____

TYPE: _____ PROJECT: _____

CATALOG #: _____

_____ = Service Program



Click icons for a list of Stocked or Quick-Ship options

ORDERING GUIDE

Example: LTR-4RD-H-SL10L-DM1-LTR-4RD-T-SL35K8MD-S

CATALOG # _____

HOUSING

LTR-4RD-H		Lumen Package		Lumen Output		Driver Options		Control Options		Voltage		Housing Options																	
Aperture/Shape/Function																													
LTR-4RD-H	4" Round Downlight New Construction Housing	SL	Standard Lumen	06L	600	DM1	0-10V Dimming to 1%	NXE	NX Enabled, Dual SmartPorts ³	Standard	120-277V	CP	Chicago Plenum ^{7,9}																
				10L	1000		DM01						0-10V Dimming to < 1%	NXWE	NX Wireless Enabled ³	34	347V ⁶	IC	IC rated ^{8,9}										
				15L	1500		DMX						DMX with RDM dimming to < 0.1% ²					NXWD	NX Wireless Enabled, Dual SmartPorts ³	EM	Emergency Battery Pack with integral test switch and indicator light ⁹								
		ML	Medium Lumen	20L	2000																2DM	Lutron Hi-Lume 2-wire Dimming to 1% (120V Forward Phase only) ²	LV	Lutron Vive Enabled, 0-10V (requires 0-10V driver)	EMR	Emergency Battery Pack with remote test switch and indicator light ⁹			
				25L	2500																					EDM	Lutron Hi-Lume EcoSystem Dimming to 1% ²	LVE	Lutron Vive Enabled, EcoSystem, (requires EDM)
				30L	3000		GTD						Generator Transfer Device ⁹																
		HL	High Lumen	35L	3500																F	Fuse							
				40L	4000																								

TRIM

LTR-4RD-T		Lumen Package		CCT		CRI		Distribution									
Aperture/Shape/Function																	
LTR-4RD-T	4" Round Downlight Light Engine/Trim Assembly	SL	Standard Lumen	27K	2700K	8	80+CRI	VNR	Very Narrow (0.3 SC/20°) ¹³								
				30K	3000K					9	90+CRI	NR	Narrow (0.4 SC/29°)				
				HL	High Lumen									35K	3500K	MD	Medium (0.7 SC/44°)
														40K	4000K		
50K	5000K ¹	XW	Extra Wide (1.2 SC/78°)														

TRIM CONTINUED

Reflector Finish		Reflector Color		Flange Color Options		Lower Trim Options		Reflector Options	
<i>Finish not applicable with painted reflectors (WC or BC)</i>		<i>Standard Clear</i>		<i>Standard matches reflector color</i>		EM		AM	
S	Specular	CG		WT		Pre-punched reflector for EM integral test switch and indicator		Antimicrobial Coating ⁵	
		BL		BT		FM			
		LW				Flush Mount Mud-in Ring ¹⁰			
		PW				WF			
		WC				Wide Flange			
		BC							
SS	Semi-Specular								
MFC	American Matte™								
VS	Softglow®								
VSS	SoftSheen™								

Accessories

- B24 Set of two (2) 24" bar hangers for T-bar ceilings
- B6 Set of two bar hangers for ceiling joist up to 24" centers
- FMR4-R Flush Mount Mud-In Ring Accessory, 4" Round
- LiteGear LiteGear® Inverter, 125VA-250VA
- LPS Series LightPower Micro-Inverter, 20VA-55VA
- MOR4-R-WH Metal Oversized Ring, 4" Round, White (8.25" outside diameter)
- MOR4-R-BL Metal Oversized Ring, 4" Round, Black (8.25" outside diameter)
- LTR-SCA4-___ Sloped Ceiling Adapter, 4", White¹²

Notes:

- 1 5000K available in 80+ CRI only.
- 2 2DM, EDM, DMX available in 10L-35L.
- 3 NX requires DM1 driver option.
- 4 WT not needed for WC, BT not needed for BC.
- 5 AM available with WC or Specular Clear (S or SWT). Consult factory for other colors.
- 6 347V requires DM1 driver option; not available in 06L or with Controls F, DTS, GTD, EM, EMR.
- 7 CP available up to 20L; not available with DMX, Controls, or EMR options.
- 8 IC available up to 20L; not available with Controls options.
- 9 Housing options (except Fuse) not available in combination.
- 10 Flush Mount Flange (FM) requires FMR accessory (sold separately).
- 11 DTS available with DM1, DM01, DALI, or EDM; not available with LVE.
- 12 Specify slope angle 5°-35° in 5° increments. Not available with EM, WF, or FM options.
- 13 VNR available up to 30L.

SRT1 EDGE-LIT

CEILING/SURFACE/GARAGE

FEATURES

- For ceiling mount and parking garage applications from an 8–15 foot mounting height
- Edge-lit flat lens for optimal visual comfort and uniformity across the lens
- Two optical distributions specifically design for parking garage and canopy applications are available making the Beacon Edge-Lit luminaire both versatile and functional
- UL/cUL listed for wet locations, IP65 and 3G vibration rated
- Occupancy sensor available for complete on/off and dimming operation



See Certification Specifications

SPECIFICATIONS

HOUSING

- Die-cast aluminum housing ensures long electrical component life and luminaire performance
- Corrosion resistant powder coat finish both protects and provides architectural appearance
- One piece molded silicone gasket ensures weather proof seal
- Thermally isolated driver mounted to dedicated bracket reduces operating temperatures and increases driver life and reliability

OPTICS

- Edge-lit acrylic light guide provides blended non-pixelated light for unprecedented visual comfort
- Choice of multiple light outputs with lumen range of 2000–6000
- Two distribution types: Type 5 Square Wide, Type 5 Concentrated
- Wide variety of CCT's and CRI's offered: 3000K (70CRI), 3000K (80CRI), 3500K (80CRI), 4000K (70CRI), 4000K (80CRI) or 5000K (70 CRI) CCT

ELECTRICAL

- 120V–277V 50/60Hz available
- 0–10V dimming drivers are RoHS compliant
- Dimming Drivers are standard and dimming leads are extended out of the luminaire unless control options require connection to the dimming leads. Must specify if wiring leads are to be greater than the 24" standard

INSTALLATION

- Standard quick mount plate over standard 4" junction box or octagonal junction box and allows for simplified fixture installation
- Standard luminaire accepts a rigid or 3/4" NPT stem for pendant mounting via wet location j-box (by others)
- Optional bird deterrent shroud available for field installation

OPTIONS/CONTROLS

- Standalone occupancy sensor available for on/off or dimming operation
- Uplight option provides approximately 800 lumens and consumes only 8 additional watts
- Vandal resistant wire guard available as an option for factory installation or as an accessory for field installation
- Please consult brand or sales representative when combining control and electrical options as some combinations may not operate as anticipated depending on your application

RELATED PRODUCTS

- [Drive Edge-Lit SRT2](#)
[Orbeon](#)
[Viper Small](#)

CERTIFICATIONS

- Listed to UL1598 for use in wet location, listed for -40°C to 40°C applications
- IDA approved with zero uplight for 3000K and warmer CCTs
- DLC® (DesignLights Consortium) Qualified. Please refer to the DLC website for specific product qualifications at www.designlights.org
- This product qualifies as a "designated country construction material" per FAR 52.225-11 Buy American-Construction Materials under Trade Agreements effective 04/23/2020. See Buy American Solutions
- IP65

WARRANTY

- 5 year warranty
- See [HLI Standard Warranty](#) for additional information

KEY DATA	
Lumen Range	2000–6800
Wattage Range	15–55W
Efficacy Range (LPW)	99–118
Reported Life (Hours)	50K
Weight lbs. (kg)	8 (3.6)

SRT1 EDGE-LIT

CEILING/SURFACE/GARAGE

ORDERING GUIDE

Example: SRT1-35-3K7-5QW-UNV-BLT-WG

 CATALOG #

Series	Engine	CCT	Distribution	Voltage	Color/Finish	Options
SRT1 Edge-Lit Parking Garage Size 1	15 15W Nominal 2000 lm	3K7 3000K, 70 CRI	5QW Type 5 Square Wide	UNV 120V- 277V	BLT Black Matte Textured	WG Wire Guard
	20 20W Nominal 2500 lm	3K8 3000K, 80 CRI	5C Type 5 Concentrated	120 120V	BLS Black Gloss Smooth	UD Uplight Module ³
	35 35W Nominal 4500 lm	35K8 3500K, 80 CRI		208 208V	DBT Dark Bronze Matte	F Single Fuse (120, 277) ¹
	55 55W Nominal 6500 lm	4K7 4000K, 70 CRI		240 240V	DBS Dark Bronze Gloss Smooth	LD3 36" Lead Length ²
		4K8 4000K, 80 CRI		277 277V	GTT Graphite Matte Textured	LD6 72" Lead Length ²
		5K7 5000K, 70 CRI			LGS Light Grey Gloss Smooth	LD9 108" Lead Length ²
					PSS Platinum Silver Smooth	SP10K 10kA Surge Protection ³
					WHT White Matte Textured	LMB Less Mounting Bracket
					WHS White Gloss Smooth	CD Continuous Dimming ⁴
					VGT Verde Green Textured	
					Color Option	
					CC Custom Colors	

Control Options	
NX Standalone	
NXOS12F	NX Distributed Intelligence™, PIR Occ. Sensor, Dimming Daylight Harvesting, up to 12' MH
Sensor Controls	
SCP-8F	Remote control programmable line voltage sensor (8-12' recommended mounting height) ⁴
SCP-20F	Remote control programmable line voltage sensor (12-20' recommended mounting height) ⁴

Accessories (Order Separately)

- SRT1-WG Wire Guard
- SRT-MB Mounting bracket for pre-installation
- SRT1-BS-XXX Bird deterrent shroud for SRT1 version, not available with uplight
- SCP-REMOTE Remote control for SCP option; order at least on per project to program and control

Notes:

- 1 Must specify voltage
- 2 Standard wire lead length 24"
- 3 SP10K or NXOS12F not available with uplight (UD)
- 4 120V or 277V only

PERFORMANCE DATA

Nominal Watts	Nominal Lumens	Distribution	5K (5000K NOMINAL 70 CRI)					4K (4000K NOMINAL 70 CRI)					3K (3000K NOMINAL 70 CRI)				
			Lumens	LPW	B	U	G	Lumens	LPW	B	U	G	Lumens	LPW	B	U	G
15	2500	5C	2470	146.61	1	0	1	2459	145.91	1	0	1	2364	140.30	1	0	1
		5QW	2378	141.15	1	0	1	2367	140.48	1	0	1	2276	135.07	1	0	1
20	3000	5C	3093	136.86	1	0	1	3078	136.21	1	0	1	2960	130.97	1	0	1
		5QW	2974	131.60	1	0	1	2960	130.97	1	0	1	2846	125.93	1	0	1
35	4500	5C	4757	131.05	2	0	1	4734	130.42	2	0	1	4552	125.41	2	0	1
		5QW	4574	126.01	2	0	1	4552	125.41	2	0	1	4377	120.58	2	0	1
55	6500	5C	6814	127.13	2	0	1	6782	126.52	2	0	1	6521	121.66	2	0	1
		5QW	6552	122.24	3	0	1	6521	121.66	3	0	1	6270	116.98	3	0	1

ELECTRICAL DATA

Nominal Watts	System Watts	Line Voltage		AMPS AC				Dimming Range	Absolute Voltage Range on 0-10V (+)	
		VAC	HZ	120	208	240	277		VAC	HZ
15	16.9	120-277	50/60	0.14	0.08	0.07	0.06	10% to 100%	0V	10V
20	21.6	120-277	50/60	0.18	0.10	0.09	0.08	10% to 100%	0V	10V
35	34.6	120-277	50/61	0.29	0.17	0.14	0.12	10% to 100%	0V	10V
55	54.9	120-277	50/62	0.46	0.26	0.23	0.20	10% to 100%	0V	10V

SRT1 EDGE-LIT

CEILING/SURFACE/GARAGE

PROJECTED LUMEN MAINTENANCE

Ambient Temp.	0	25,000	*TM-21-11 36,000	50,000	100,000	Calculated L ₇₀ (Hours)
25°C / 77°F	1.00	0.98	0.96	0.95	0.89	278,000
40°C / 104°F	0.99	0.98	0.96	0.94	0.88	264,000

LUMINAIRE AMBIENT TEMPERATURE FACTOR (LATF)

Ambient Temperature		Lumen Multiplier
0°C	32°F	1.03
10°C	50°F	1.01
20°C	68°F	1.00
25°C	77°F	1.00
30°C	86°F	0.99
40°C	104°F	0.98
50°C	122°F	0.97

DIMENSIONS

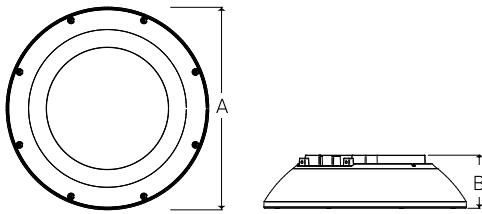

A	B	Weight
12" (304mm)	3.1" (78mm)	8lbs (3.6kg)

ADDITIONAL INFORMATION

FINISH OPTIONS



Wire Guard

An optional wire guard can be specified at the factory or as an accessory for field installation.



Bird Deterrent

An optional bird shroud deterrent can be specified at the factory or as an accessory for field installation.



TYPE SG

SIGNWAVE® 3 (INDOOR/OUTDOOR)

SW3-SERIES | NARROW VIEW FLEXIBLE LIGHTING SYSTEM

Fixture Type: _____

Project: _____

Location: _____

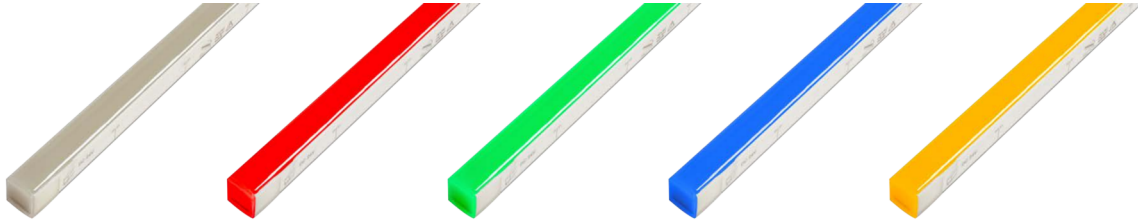

Color/Kelvin	WHITE (Specify CCT)	RED	GREEN	BLUE	AMBER	RGBW	CT (2500+5000K)
Wavelength	N/A	620-630nm	520-530nm	465-475nm	585-595nm	N/A	N/A
Wattage	3.7W/ft	2.2W/ft	3.7W/ft	3.7W/ft	2.2W/ft	4.6W/ft	3.7W/ft
Power Feed	Every 26ft	Every 39ft	Every 26ft	Every 26ft	Every 39ft	Every 21ft	Every 26ft
Production Intervals	2.188"	3.25"	2.188"	2.188"	3.25"	3.25"	3.25"

PRODUCT FEATURES

- Dimmable
- 50,000 hour life
- Flat profile for streamline projects
- Horizontal or vertical bending option
- IP67 or IP68 option
- UL-listed for indoor and outdoor use
- Factory-installed power feed
- Injection-molded flush end caps
- For use with 24V power supplies

SPECIFICATIONS

Series	SW3 - Signwave® 3
Input Voltage	24V DC
Max Run Length	Unlimited, Refer to Power Feed Above
Lumens	162 Lm/ft (White)
Beam Angle	160°
Dimensions	0.625"(16mm) × 0.688"(17mm)
CRI	80+
Dimming Options	PWM, Triac, 0-10V, DMX, Hi-lume
Temp Range	-4°F (-20°C) to 113°F (45°C)



BENDING OPTIONS & PROFILE DIMENSIONS

Horizontal

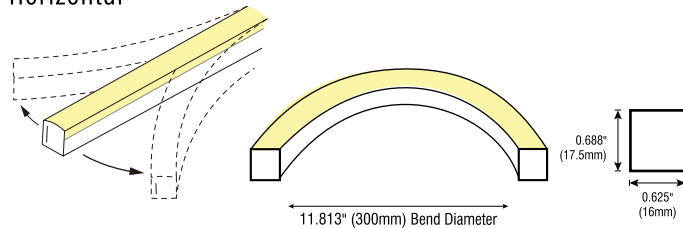

Vertical

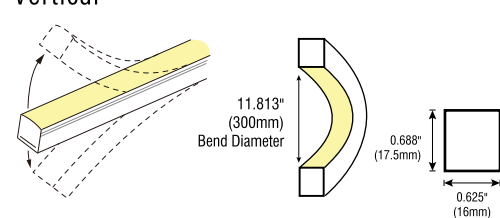

Conforms to ANSI/UL Standard 2108
Certified to CAN/CSA Standard C22.2 No. 250.0





SIGNWAVE® 3 (INDOOR/OUTDOOR)

SW3-SERIES | NARROW VIEW FLEXIBLE LIGHTING SYSTEM

IP67 OPTIONS

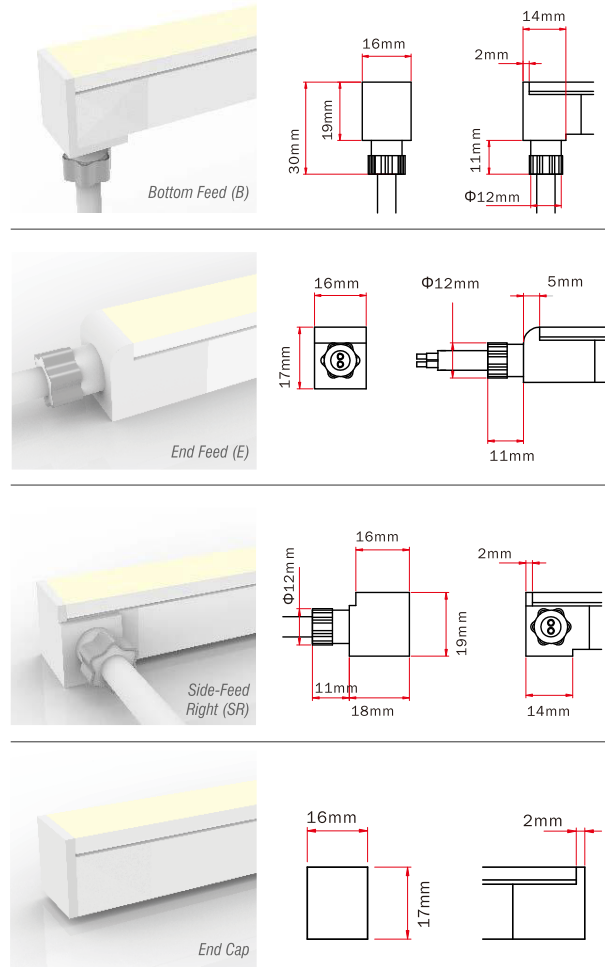

IP68 OPTIONS

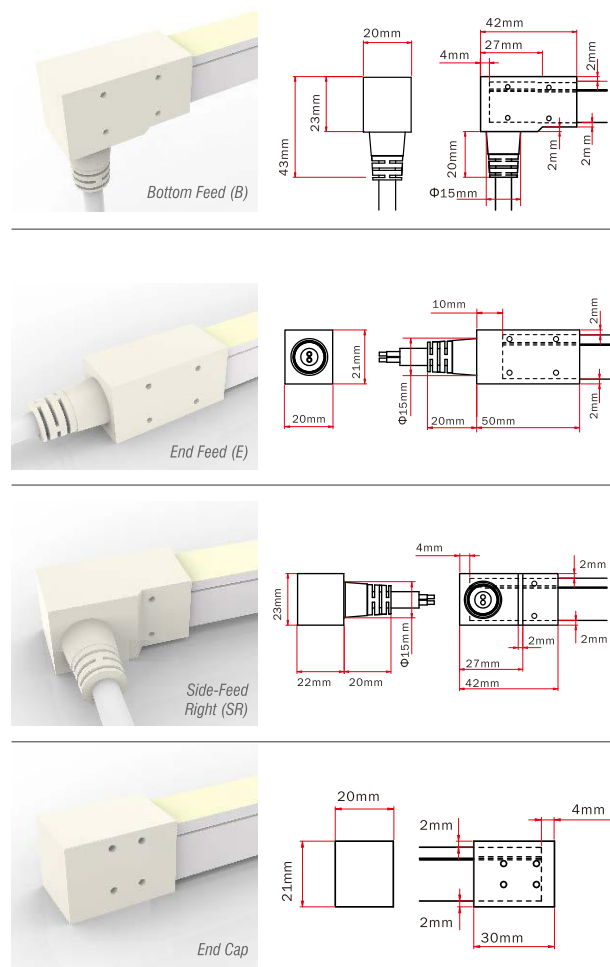

ORDERING INFORMATION

Example: **SW3-36-RGBW-VR-E-S-IP67**

Series	Length (Unlimited)	Color	Bending	Feed Point	Feed Length	Rating
SW3						
SW3 - Signwave 3	Inches	27K - 2700K 30K - 3000K 35K - 3500K 40K - 4000K 45K - 4500K 50K - 5000K RD - Red GRN - Green BL - Blue AM - Amber RGBW - Color Changing CT - Color Tuning	VR - Vertical HZ - Horizontal (Not available in RGBW)	B - Bottom Feed SL - Side-Feed Left SR - Side-Feed Right E - End Feed	S - Standard (118 inch) Inches - Custom length (inches).	IP67 IP68



SIGNWAVE® NARROW VIEW ACCESSORIES

FOR SIGNWAVE™ 3 SERIES

ALUMINUM SERRATED CHANNEL

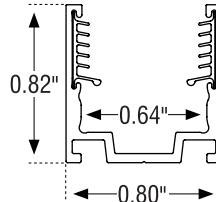
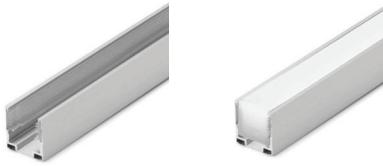

Model	SW-K-AL-CH-SR-2M
Material	Aluminum
Length	78.75" (2m)
Width	0.80" (20.2mm)
Height	0.82" (20.8mm)
Internal Width	0.64" (16.3mm)

ALUMINUM SERRATED CLIP

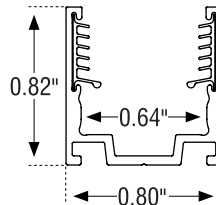
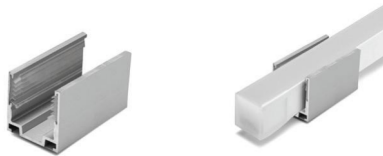

Model	SW-K-CLP-AL-SR
Material	Aluminum
Length	0.79" (20mm)
Width	0.80" (20.2mm)
Height	0.82" (20.8mm)
Internal Width	0.64" (16.3mm)

ALUMINUM SERRATED FLEX CHANNEL

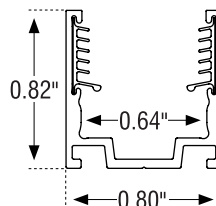

Model	SW-K-CH-AL-FLX-1M
Material	Aluminum
Length	39.3" (1m)
Width	0.80" (20.2mm)
Height	0.82" (20.8mm)
Internal Width	0.64" (16.3mm)

SIDE MOUNTING BRACKET

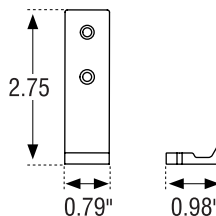

Model	SW-CLP-RA
Material	Aluminum
Length	0.79" (20mm)
Width	0.98" (25mm)
Height	2.75" (70mm)

REQUIRED: Must be paired with channel.